

X

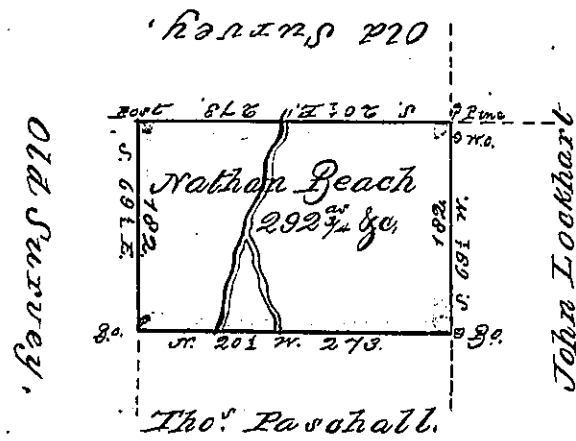

A draft of a tract of land called  
 Situate on the waters of Awapualpia Creek  
 in the County of Luzerne containing two hun-  
 dred & ninety two Acres  $\frac{3}{4}$  & allowance -  
 Surveyed for Nathan Beach the 12<sup>th</sup> day of  
 August 1794 by virtue of a warrant dated  
 the 13<sup>th</sup> day of Jan<sup>y</sup>. 1794 -

by Wm Gray U.S.

Lewis Brockhead Esq<sup>r</sup> }  
 Suror. Genl. }

IN TESTIMONY that the above is a copy of the original remaining on file in the  
 Department of Internal Affairs of Pennsylvania, made con-  
 formably to an Act of Assembly approved the 16th day of  
 February, 1833, I have hereunto set my Hand and caused  
 the Seal of said Department to be affixed at Harrisburg, this  
 Fifteenth day of September 1876

*Wm M. Anderson*  
 Secretary of Internal Affairs